

THEATRE ESTIM, WINCHESTER  
 BFF 523  
 LONG SECTION A/A THROUGH  
 AUDITORIUM  
 AL40

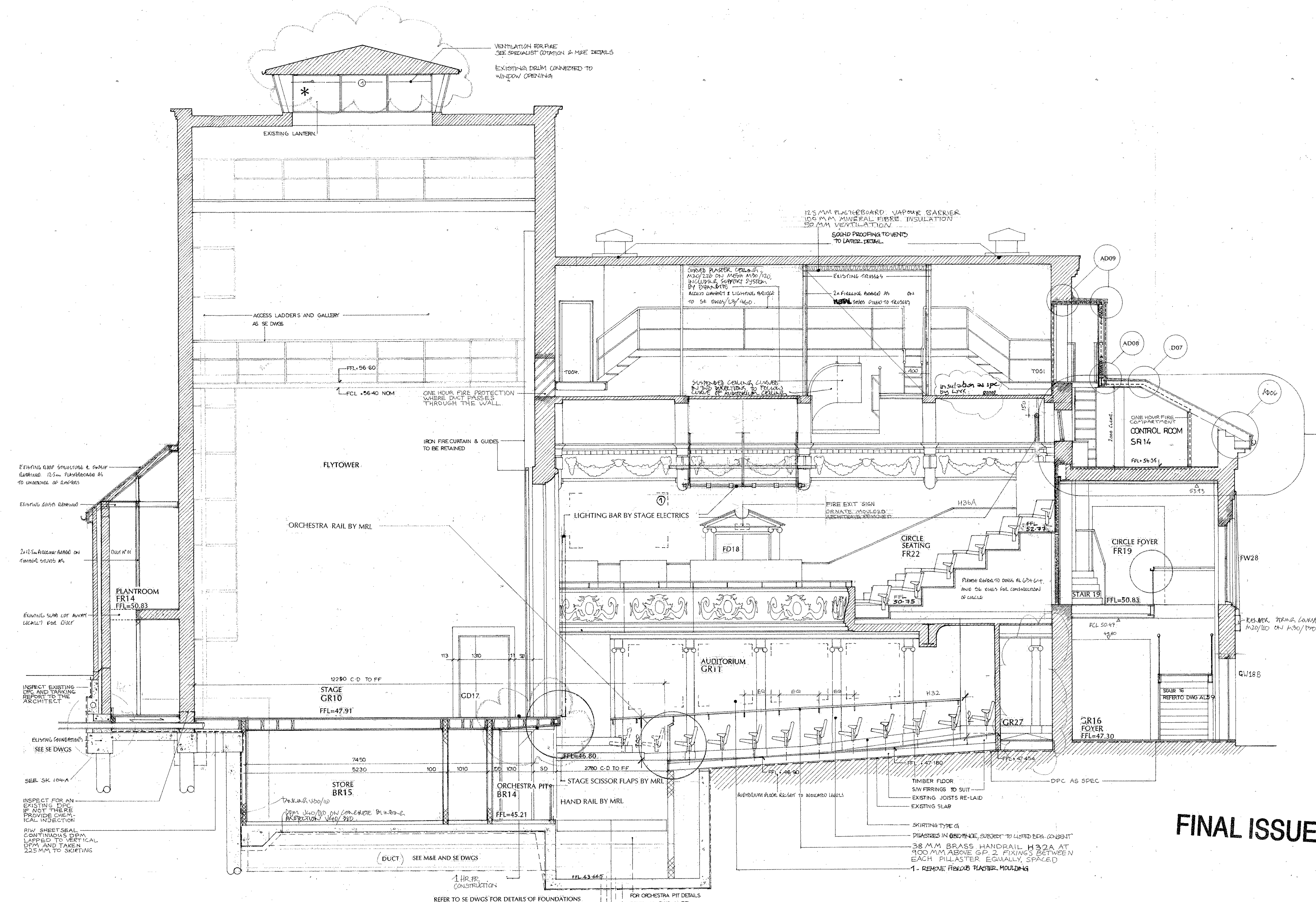

- NOTES**
- DOORS**
  - ⊙ INDICATES 30 MIN SELF CLOSING FIRE DOOR INCORPORATING A SMOKE SEAL
  - ⊙⊙ INDICATES 60 MIN SELF CLOSING FIRE DOOR INCORPORATING A SMOKE SEAL
  - WALL HATCHING**
  - BRICKWORK
  - BLOCKWORK
  - STUD WORK
  - STUD WITH QUILT
  - INSULATION
  - MAKING GOOD
  - EXISTING WALL

\* LANTERN VENTS LINKED TO FIRE CONTROL SYSTEM AND PANEL FOR FIRE CONTROL SYSTEM DETAILS SEE M+E SERVICES INFORMATION

- REV M - 25.01.01 - NOTES ADDED - VENTILATION LOCATION
- REV L - 06.12.00 - LIGHTING BARS ADDED - STAGE SCISSOR FLAP SHOWN - ORCHESTRA PIT GUARD RAILS SHOWN
- REV K - ROOF INSULATION ADDED - FIRE EXIT SIGN FD18, PILLASTER TO GR27, MOULDING REMOVED FROM FD18
- REV J - 17.08.00 - HANDRAIL FIXINGS
- REV I - 06.07.00 - NOTATION RELATING TO DPC/TANKING AND FIRE PROOF COMPARTMENTS
- REV H - VENTS NOTES ADDED - 24.05.00 BALUSTRADE CIRCLE FOYER
- REV G - NEW SKIRTING GR FLOOR AUDITORIUM NEW HANDRAIL AUDITORIUM REMOVE FIBROUS PLASTER MOULDING
- REV F - 30.05.00 - FLOOR EGRESS SHOWN IN AUDITORIUM - CROSS REF ADDED TO CONTROL RA
- REV E - 11.02.1999 - SUSPENDED CEILING ADDED TO FOYER
- REV D - NOTES ADDED TO LIGHTING PACKAGE ACCESS TO CEILING/TIMBER TO BASEMENT
- REV C - 06.03.98 FOUNDATIONS - BALUSTRADE AMENDED
- REVISION B - 03.78 LIGHTING DESIGN REVISIONED
- REVISION A - 18.05.95 MATERIALS BOOK, SEALS/FLOORING FINISHED, DIMS & NOTES AMEND

**FINAL ISSUE**

**BURRELL · FOLEY · FISCHER**  
 BURRELL FOLEY FISCHER · ARCHITECTS & URBAN DESIGNERS  
 15 MONMOUTH STREET · COVENT GARDEN · LONDON WC2H 9DA  
 TEL 0171 836 5097 · FAX 0171 379 6619

**JOB** WINCHESTER THEATRE ROYAL

**FOR** WINCHESTER THEATRE FUND

**AT** JEWRY STREET, WINCHESTER, HAMPSHIRE SO23 6SB

**DRAWING/TITLE** SECTION A-A

<b>DATE</b> MAY 1997	<b>SCALE</b> 1:50
<b>JOB N°</b> BFF 523	<b>DWG N°</b> AL 40 M

Copyright